



HANVEY
ENGINEERING & DESIGN



CLEANING THE BATHING BEAUTY



Tools needed:

- CPAP Hose cleaning brush (At least 6ft)
- Phillips Screwdriver
- 7/16-Inch Nut Driver (For Bathing Beauty “Feet”)
- Plastic brush for the crevices.

Start by running the desired disinfectant through the bather in the tub for 10 minutes.

No Bleach/Chlorine or Peroxide-based disinfectant/cleaners. Bleach products will void its warranty.

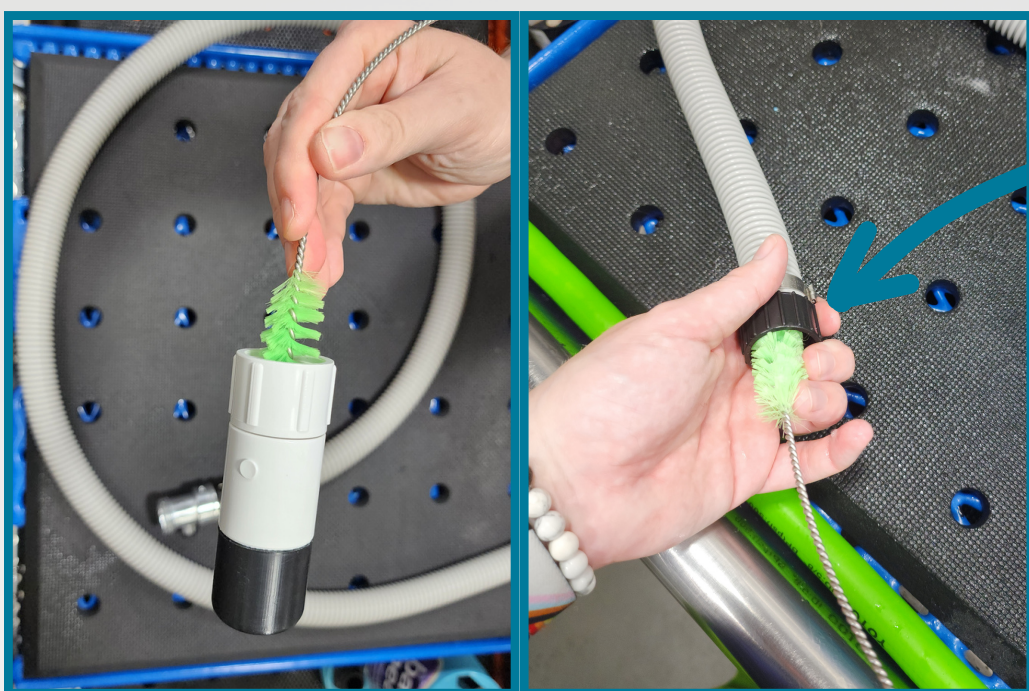

The Hose and Nozzle:

- Detach the spray nozzle from the flow regulator and use the brush end of the CPAP brush to clean the nozzle.
- Detach the hose. Push the CPAP brush through the hose with the desired disinfectant/cleaner.

Note: If the rubber seal dislodges from the nozzle, it can be put back in.

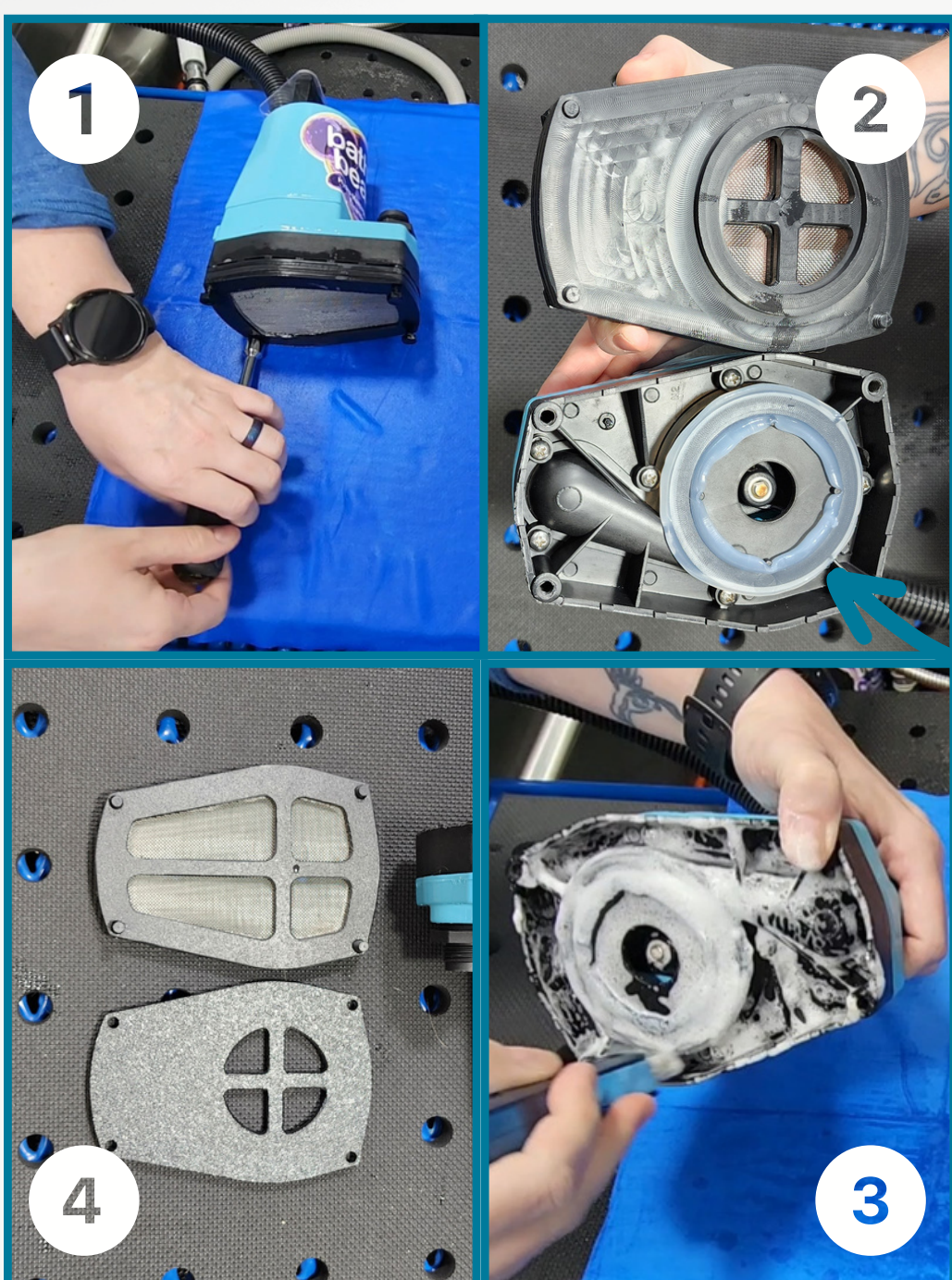

The Bathing Beauty Screen and Bottom:

- 1 • Using the 7/16-inch Nut Driver, loosen the black “feet.” Do not bend or flex the “feet,” as they are plastic and can break.
- 2 • Remove the screen assembly and spray or soak in the desired disinfectant/cleaner. Set aside.
 - Spray the desired disinfectant/cleaner in the crevices.
- 3 • Use a plastic brush to clean the crevices.
 - Use caution not to dislodge the silicone seal. Over time it may degrade and detach.
- 4 • When finished, use a spray hose to rinse the underside and the screen assembly.
- 4 • Reassemble the two flat sides of the bather bottom and secure with the “feet”. The side with the raised circle lip aligns with the silicone ring on the bottom of the bather.

Note: If the Bathing Beauty “feet” become damaged, they can be replaced at hanvey.com.
If the silicone seal becomes dislodged, a new one can be reapplied with silicone caulk.

Email support@gohanvey.com for assistance.